

PROPERTY RECORD CARD

General Information

Owner Name:	SAPP JOHN L & CAROLE J DAYTON	Alternate Key:	3777132
Mailing Address:	17651 SAWGRASS RUN TAVARES, FL 32778-9016 Update Mailing Address	Parcel Number: ⓘ	36-19-26-2005-00C-02000
		Millage Group and City:	DI02 (UNINCORPORATED)
		2019 Total Certified Millage Rate:	15.0425
		Trash/Recycling/Water/Info:	My Public Services Map ⓘ
Property Location:	17651 SAWGRASS RUN TAVARES FL 32778 Update Property Location ⓘ	Property Name:	-- Submit Property Name ⓘ
		School Information:	School Locator & Bus Stop Map ⓘ School Boundary Maps ⓘ
Property Description:	THE DEER ISLAND CLUB SECOND REPLAT SUB LOT 20 PARCEL C PB 39 PGS 9-20 ORB 5030 PG 506		
<small>NOTE: This property description is a condensed/abbreviated version of the original description as recorded on deeds or other legal instruments in the public records of the Lake County Clerk of Court. It may not include the Public Land Survey System's Section, Township, Range information or the county in which the property is located. It is intended to represent the land boundary only and does not include easements or other interests of record. This description should not be used for purposes of conveying property title. The Property Appraiser assumes no responsibility for the consequences of inappropriate uses or interpretations of the property description.</small>			

Land Data

Line	Land Use	Frontage	Depth	Notes	No. Units	Type	Class Value	Land Value
1	SINGLE FAMILY GOLF (0138)	0	0		1	LT	\$0.00	\$90,000.00

[Click here for Zoning Info](#) ⓘ [FEMA Flood Map](#)

Residential Building(s)

Building 001

Residential	Single Family	Building Value: \$492,037.00						
Summary								
Year Built: 2005	Total Living Area: 4250 ⓘ	Central A/C: Yes		Attached Garage: Yes				
Bedrooms: 3	Full Bathrooms: 4	Half Bathrooms: 1		Fireplaces: 0				
Incorrect Bedroom, Bath, or other information? ⓘ								
Section(s)								
Section No.	Section Type	Ext. Wall Type	No. Stories	Floor Area	Finished Attic	Basement	Basement Map Finished	Basement Map Color
1	FINISHED LIVING AREA (FLA)	Stucco/Brick (003)	1	3562	N	0%	0%	<input type="checkbox"/>
2	OPEN PORCH FINISHED (OPF)	No Wall Type (000)	1	48	N	0%	0%	<input type="checkbox"/>
3	GARAGE FINISHED STONE (GCF)	Stucco/Brick (003)	1	1128	N	0%	0%	<input type="checkbox"/>
4	FINISHED AREA	Wood (001)	1	688	N	0%	0%	<input type="checkbox"/>

UPPER STORY (FUS)

5	OPEN PORCH UNFINISHED (OPU)	No Wall Type (000)	1	24	N	0%	0%	<input type="checkbox"/>
6	OPEN PORCH FINISHED (OPF)	No Wall Type (000)	1	433	N	0%	0%	<input type="checkbox"/>

[View Larger / Print / Save](#)

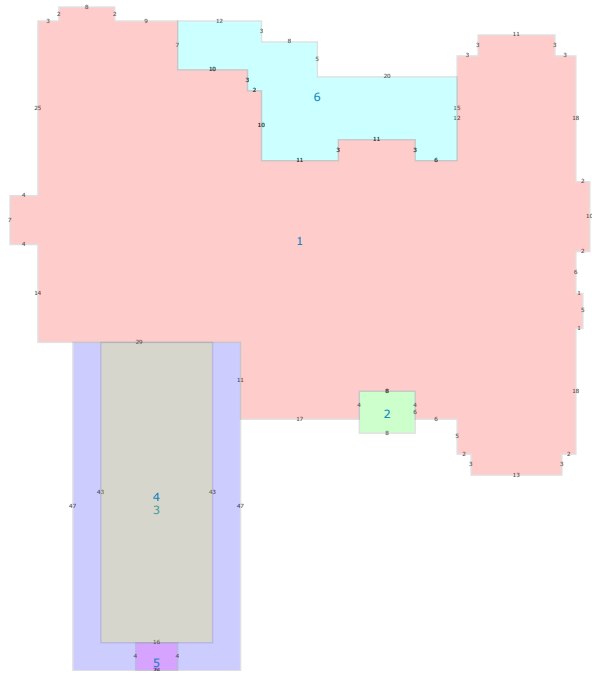

Miscellaneous Improvements

No.	Type	No. Units	Unit Type	Year	Depreciated Value
0001	SWIMMING POOL (POL)	528	SF	2006	\$15,708.00
0002	POOL DECKING (PLD)	1099	SF	2006	\$5,639.00
0004	SCREENED ENCLOSED STRUCTURE (SEN)	3057	SF	2006	\$6,955.00

Sales History

NOTE: This section is not intended to be a complete chain of title. Additional official book/page numbers may be listed in the property description above and/or recorded and indexed with the Clerk of Court. [Follow this link to search all documents by owner's name.](#)

Book/Page	Sale Date	Instrument	Qualified/Unqualified	Vacant/Improved	Sale Price
5030 / 506	11/21/2017	Warranty Deed	Qualified	Improved	\$710,000.00
4862 / 1792	11/4/2016	Warranty Deed	Qualified	Improved	\$710,000.00
2542 / 1419	3/22/2004	Warranty Deed	Qualified	Vacant	\$90,000.00
2259 / 2150	1/24/2003	Warranty Deed	Qualified	Vacant	\$65,800.00

[Click here to search for mortgages, liens, and other legal documents.](#)

Values and Estimated Ad Valorem Taxes

Values shown below are 2020 WORKING VALUES.

The Market Value listed below is not intended to represent the anticipated selling price of the property and should not be relied upon by any individual or entity as a determination of current market value.

Tax Authority	Market Value	Assessed Value	Taxable Value	Millage	Estimated Taxes
LAKE COUNTY BCC GENERAL FUND	\$610,339	\$552,933	\$502,933	5.07340	\$2,551.58
LAKE COUNTY MSTU AMBULANCE	\$610,339	\$552,933	\$502,933	0.46290	\$232.81
LAKE COUNTY MSTU FIRE	\$610,339	\$552,933	\$502,933	0.47040	\$236.58

SCHOOL BOARD STATE	\$610,339	\$552,933	\$527,933	3.88500	\$2,051.02
SCHOOL BOARD LOCAL	\$610,339	\$552,933	\$527,933	2.99800	\$1,582.74
LAKE COUNTY MSTU STORMWATER	\$610,339	\$552,933	\$502,933	0.49570	\$249.30
ST JOHNS RIVER FL WATER MGMT DIST	\$610,339	\$552,933	\$502,933	0.24140	\$121.41
LAKE COUNTY VOTED DEBT SERVICE	\$610,339	\$552,933	\$502,933	0.11000	\$55.32
LAKE COUNTY WATER AUTHORITY	\$610,339	\$552,933	\$502,933	0.35570	\$178.89
NORTH LAKE HOSPITAL DIST	\$610,339	\$552,933	\$502,933	0.95000	\$477.79
				Total: 15.0425	Total: \$7,737.44

Exemptions Information

This property is benefitting from the following exemptions with a checkmark ✓

✓ Homestead Exemption (first exemption up to \$25,000)	Learn More View the Law
✓ Additional Homestead Exemption (up to an additional \$25,000)	Learn More View the Law
Limited Income Senior Exemption (applied to county millage - up to \$50,000)	Learn More View the Law
Limited Income Senior Exemption (applied to city millage - up to \$25,000)	Learn More View the Law
Limited Income Senior 25 Year Residency (county millage only-exemption amount varies)	Learn More View the Law
Widow / Widower Exemption (up to \$500)	Learn More View the Law
Blind Exemption (up to \$500)	Learn More View the Law
Disability Exemption (up to \$500)	Learn More View the Law
Total and Permanent Disability Exemption (amount varies)	Learn More View the Law
Veteran's Disability Exemption (\$5000)	Learn More View the Law
Veteran's Total and Permanent Disability Exemption (amount varies)	Learn More View the Law
Veteran's Combat Related Disability Exemption (amount varies)	Learn More View the Law
Deployed Servicemember Exemption (amount varies)	Learn More View the Law
First Responder Total and Permanent Disability Exemption (amount varies)	Learn More View the Law
Surviving Spouse of First Responder Exemption (amount varies)	Learn More View the Law
Conservation Exemption (amount varies)	Learn More View the Law
Tangible Personal Property Exemption (up to \$25,000)	Learn More View the Law
Religious, Charitable, Institutional, and Organizational Exemptions (amount varies)	Learn More View the Law
Economic Development Exemption	Learn More View the Law
Government Exemption (amount varies)	Learn More View the Law

Exemption Savings ⓘ

The exemptions marked with a ✓ above are providing a tax dollar savings of:
\$580.07

Assessment Reduction Information (3% cap, 10% cap, Agricultural, Portability, etc.)

This property is benefitting from the following assessment reductions with a checkmark ✓

✓ Save Our Homes Assessment Limitation (3% assessed value cap)	Learn More View the Law
Save Our Homes Assessment Transfer (Portability)	Learn More View the Law
Non-Homestead Assessment Limitation (10% assessed value cap)	Learn More View the Law
Conservation Classification Assessment Limitation	Learn More View the Law
Agricultural Classification	Learn More View the Law

Assessment Reduction Savings

The assessment reductions marked with a ✓ above are providing a tax dollar savings of: **\$863.53**

NOTE: Information on this Property Record Card is compiled and used by the Lake County Property Appraiser for the sole purpose of ad valorem property tax assessment administration in accordance with the Florida Constitution, Statutes, and Administrative Code. The Lake County Property Appraiser makes no representations or warranties regarding the completeness and accuracy of the data herein, its use or interpretation, the fee or beneficial/equitable title ownership or encumbrances of the property, and assumes no liability associated with its use or misuse. See the posted [Site Notice](#).

Copyright © 2014 Lake County Property Appraiser. All rights reserved.
Property data last updated on March 22, 2020.

Site Notice